

CLIP GEAR FOCUS RINGS

Mounting Instructions

Delivery Content

- Small and large gear ring
- Small and large mounting ring
- 8 screws M2
- C-mount adapter
- 4 set screws

Necessary tools

- Gear set fitting the c-mount lens
- Calibrated C-mount lens
- Screwdriver size 1
- Allen key 1,3 mm ?

Order Information

Art No.	Description
24148	C-mount lens accessory kit for 12 mm lens (#23104)
24563	C-mount lens accessory kit for 16 mm lens (#23105)
24147	C-mount lens accessory kit for 25 / 35 / 50 mm lens (#23106/23107/23108)

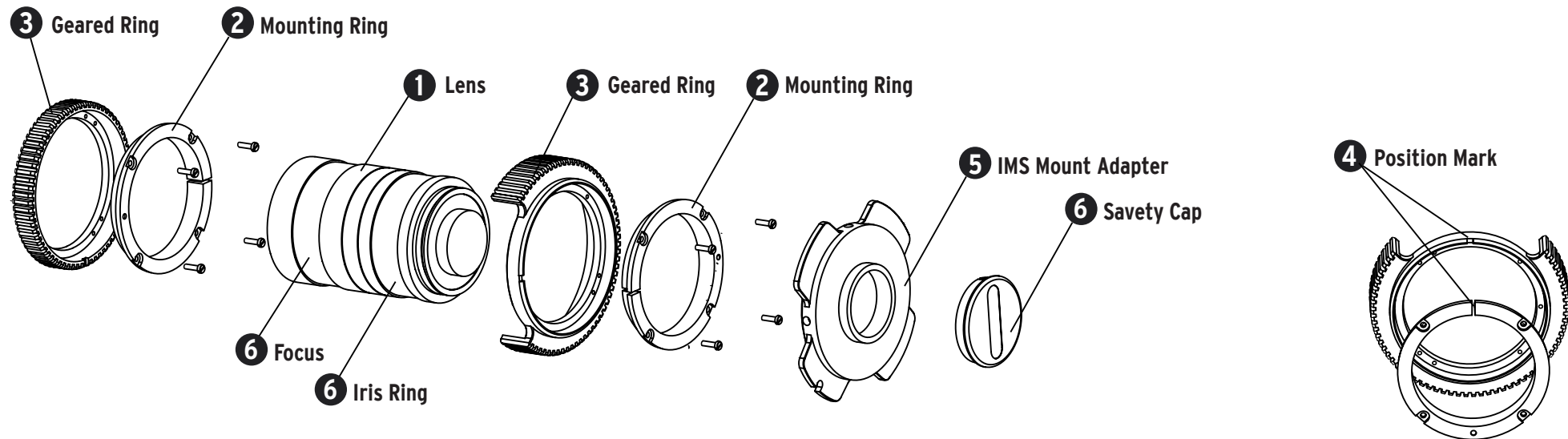

Mounting Instructions

- 1) Remove both rubber bands from the lens body including small bleach stripes below them
Remove the C-mount from the rear of the lens
- 2) Prepare small gear ring and small mounting ring with 4 screws. Make sure the slot in the mounting ring meets the position mark inside of the gear ring **4**
- 3) Mount the prepared gear ring onto the lenses focus ring. Be careful to adjust 4 screws equally and smoothly
- 4) Repeat step 2) to 3) with the larger gear ring set and attach to the iris ring of the lens. Make sure the iris scale on the lens is centred to the small slot on the gear ring
- 5) Mount the IMS mount adapter and fix with 4 set screws on the side of the IMS mount.

Notes

- 1) The first models of the C-mount lens accessory kits used small plastic discs so adjust the mount. Do not interchange these between the different kits
- 2) Use the IMS mount adapter marked with 16 mm only for the 16 mm lenses
- 3) Use mounting rings marked with a white dot only for 12 mm lenses

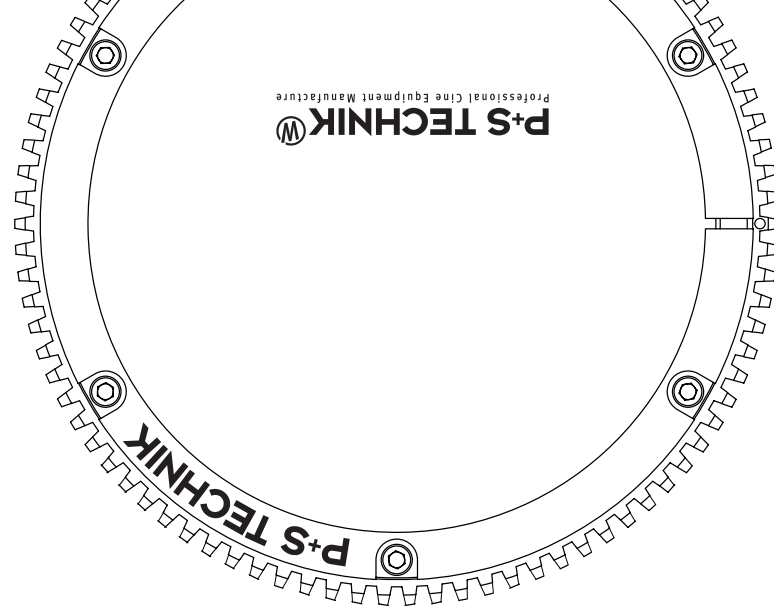

CLIP GEAR FOCUS RINGS

for P+S Technik C-mount lenses

